

OMNI-SKATE

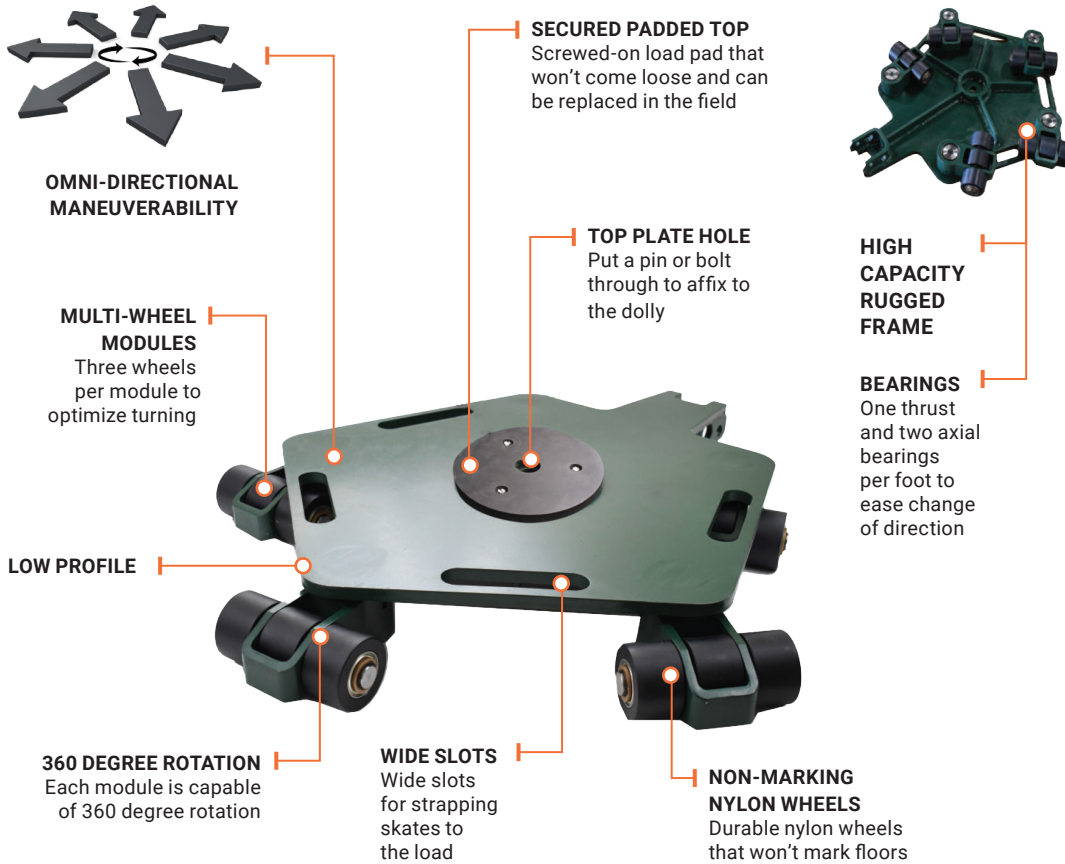

AVAILABLE IN 3, 6, 8 AND 10 TONS!



Accessories



STABILIZER BAR (OPTIONAL)
Stabilize the 2 rear skates in a conventional 3 point machinery moving application



HANDLE (OPTIONAL)
Optional pulling handle available

Model	Loading Capacity	Wheel Type	Height	Width	Length	Wheel Diameter	Wheel Numbers	Pad Diameter	Weight
OMNI-3	3 ton	NYLON	4.63"	18.937"	22.562"	Ø 3.13	6	Ø 8"	68 lb/31 kg
OMNI-6	6 ton	NYLON	4.63"	24.125"	30.125"	Ø 3.13	9	Ø 8"	111 lb/50 kg
OMNI-8	8 ton	NYLON	4.63"	22.9375"	31.4375"	Ø 3.13	12	Ø 8"	139 lb/63 kg
OMNI-10	10 ton	NYLON	4.63"	31.375"	38.75"	Ø 3.13	15	Ø 8"	185 lb/84 kg



12 Timber Lane • Marlboro, New Jersey 07746 • USA
tel: 732.462.6277 | fax: 732.462.6355 | e-mail: sales@hilmanrollers.com

The specifications are given as general information only and are not binding. Hilman Rollers reserves the right to change specifications or make alterations to products, parts or accessory equipment at any time without prior notice and for any reason whatsoever.